

WELCARE 
NURTURE

WEARABLE ELECTRIC BREAST PUMP

Model: WNB100



Instruction Manual & Warranty Information



Read Instructions Carefully Before Use

Thank you for purchasing this Welcare Nurture Wearable Electric Breast Pump.



Please keep this instruction manual in a safe place where it is readily available.

Note: *The illustrations in this manual may differ slightly from the product itself.*

Contents

Important Safety Information	4
Safety Warnings	5
Features	6
*Anti-Backflow Function	6
Package Contents	6
Breast Pump Components	7
Wearable Electric Breast Pump Display	7
Adjustable Modes	8
Operating Display	8
Running Time Display	8
Funnel Inserts	9
Before Using the Electric Breast Pump	9
Assembling the Electric Breast Pump	10
Charging the Electric Breast Pump	12
Using the Electric Breast Pump	13
Storage of Breast Milk	16
Cleaning and Maintenance	16
Storage	17
Troubleshooting	18
Replacement Accessories (sold separately)	19
Symbol Explanation	20
Technical Data	21
Product Warranty Information	22
Warranty Form	25

Important Safety Information



Caution

Read this section thoroughly before using the product. Please ensure you observe the safety instructions to avoid accidents, injury, and damage.

Intended Purpose

The Welcare Nurture Wearable Electric Breast Pump is intended to be used to express and collect milk from the breast. The device is intended for single person use.

Limitations

- **DO NOT** use this product for anything other than its intended purpose and only use as described in this manual.
- The Welcare Nurture Wearable Electric Breast Pump is a non-professional appliance designed for private use.

This product is not a therapeutic device. Do not use as a substitute for medical attention.

Safety Warnings

- This product is **NOT** intended for use by persons with limited physical, sensory, or mental abilities or lacking experience and/or knowledge, unless they are supervised by a person responsible for their safety or have received and understand the instructions/safety warnings for use of the product from this person in advance.
- Keep the product and its components out of reach of children.
DO NOT let children play with the product.
- Keep children away from the packaging material.
- This is a single-user product. Use by more than one person may present a health risk.
- If you become pregnant while breastfeeding or breast pumping, consult with a licensed healthcare professional before continuing.
- There should be no pain when using your breast pump. If you feel pain, try using the pump on a lower suction level or stop using and talk to your healthcare professional.
- Do not continue to use the pump once your milk has stopped flowing.
- Wash all parts that come into contact with your breast and breast milk after every use.
- **DO NOT** drop or put heavy objects on the product.
- Never immerse the Pump Motor into water or drop into other liquids.
- **DO NOT** use the device while charging.
- **DO NOT** expose the product to temperatures of over 40°C while in use.
- **DO NOT** use while driving.
- **DO NOT** allow the product to come into contact with any sharp objects, as this could cause damage to the product.
- **DO NOT** use while bathing or showering.
- **DO NOT** run water over the pump unit.

Features

- 3 Modes: Massage, Suction & Expression
- Adjustable Suction Levels (9 levels)
- *Anti-Backflow Function
- Rechargeable Lithium Battery
- LED Screen
- USB Recharging
- Ultra Quiet Operation
- Easy Cleaning
- Auto Shut-off
- Capacity to hold up to 150mL of milk

*Anti-Backflow Function

The anti-backflow protection system prevents milk from flowing back into the pump motor maintaining the hygiene of the breast milk.

Package Contents

- 1 x Breast Pump
- 3 x Funnel Inserts (3 sizes)
- 1 x Type-C USB Charging Cable
- 1 x Storage Bag
- 1 x Bra Strap
- 1 x Instruction Manual & Warranty Information

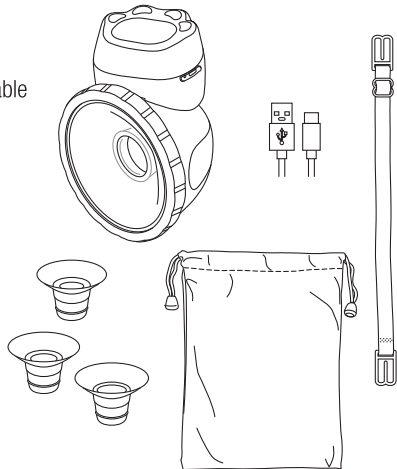

Breast Pump Components



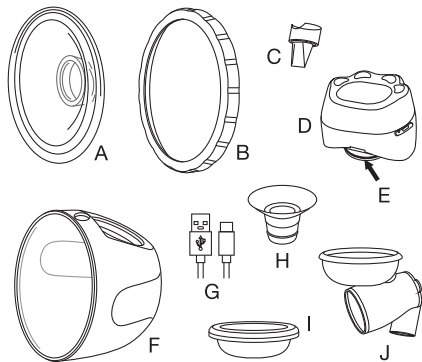

- A. Breast Shield
- B. Lock Ring
- C. Silicone Valve
- D. Pump Motor
- E. Silicone Seal
- F. Milk Collector
- G. USB Charging Cable
- H. Funnel Insert
- I. Silicone Diaphragm
- J. Linker

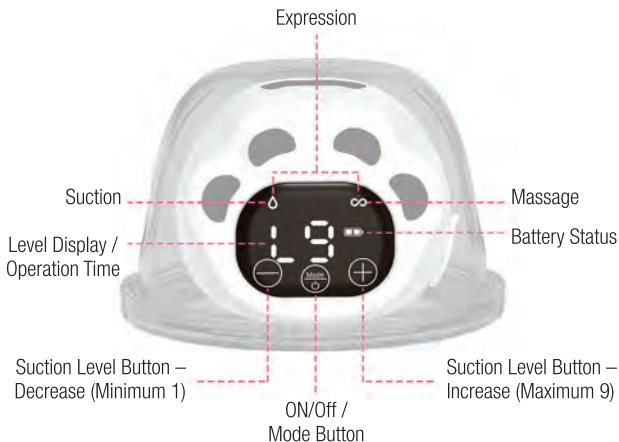

Wearable Electric Breast Pump Display



Adjustable Modes

-  **Massage:** A gentle and rapid pumping rhythm to encourage milk flow.
-  **Suction:** Once the milk starts flowing, the pumping frequency decreases.
-   **Expression:** The pumping frequency alternates between fast and slow, starting with a massaging technique to promote rapid milk flow.

Operating Display

Suction Levels

L1 ~ L9



Massage Level 9

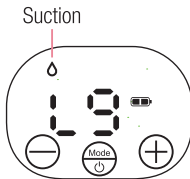

Suction Level 9

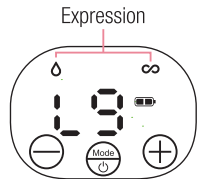

Expression Level 9

Running Time Display

The display shows the running time between 01 to 30 minutes.

01 ~ 30



Funnel Inserts

A mother's nipple can vary in size. Choose the appropriate Funnel Insert according to your nipple size.

For the correct sizing, measure the diameter of your nipple.

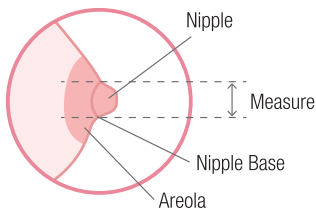

Select the funnel insert that is slightly larger than your nipple.

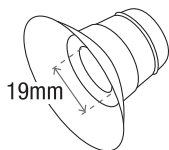

Small

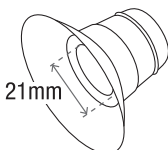

Medium

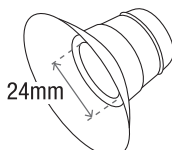

Large

Note: If the funnel insert is too large for the nipple, leakage may occur. If the funnel is too small for the nipple, a tingling sensation may be felt and a less amount of milk may be extracted.

Before Using the Electric Breast Pump

- Carefully remove all packaging materials and keep the enclosed documents in a safe place.
- **Keep the packaging, product, and its components out of reach of children.**
- Check the product is intact. **DO NOT** use if broken.

If any abnormalities are detected, please contact our service centre:

In Australia - 1800 807 464

In New Zealand - 0800 523 583

Assembling the Electric Breast Pump

Wash and sterilise the breast pump before use. Refer pages 16–17.



Caution

Before assembling the pump, please ensure all parts are dry.

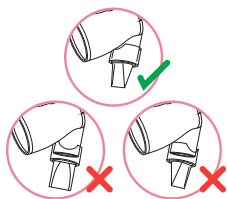
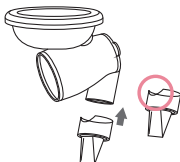
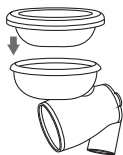

1. Place the **Silicone Diaphragm (I)** into the **Linker (J)**. Gently press around the edges of the **Diaphragm** to seal completely.

2. Place the **Silicone Valve (C)** securely to the base of the **Linker**.

Please note the correct Valve position.



Internal Slot



3. Place the assembled **Linker** into the internal slot of the **Milk Collector (F)**.

4. Gently press to ensure the **Linker** is secure.

Note: Ensure the Valve is facing downwards.

Assembling the Electric Breast Pump (cont'd)



5. Gently press the assembled **Linker** ensuring the **Diaphragm** is firmly sealed within the **Milk Collector**.

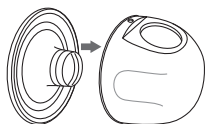

6. Attach the **Silicone Breast Shield (A)** onto the **Milk Collector**.

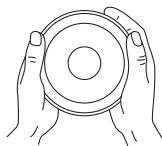

7. Gently press the edges of the **Silicone Breast Shield** to ensure they are securely sealed.

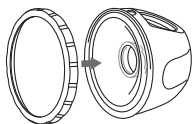

8. Place the **Lock Ring (B)** on the **Milk Collector**.

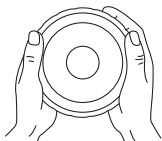

9. Gently press the **Lock Ring** to ensure the **Milk Collector** is secured.



10. The **Milk Collector** is now assembled.



11. Press the **Pump Motor (D)** onto the **Milk Collector** to ensure a secure fit.

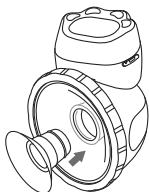

12. Choose the preferred **Funnel Insert (H)** according to your nipple size.
(Refer size guide pg 9)

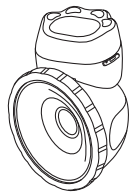

13. The **Breast Pump** is now fully assembled.

Charging the Electric Breast Pump

Please ensure that the product is fully charged prior to use.

1. Unplug the dust plug and connect the charging cable to the pump charging port.

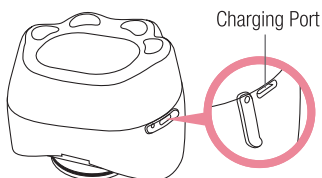

2. Plug the charging cable into a USB power adaptor or port.
3. During charging, the battery indicator will flash continuously.

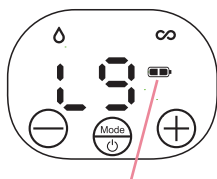

Battery Fully Charged

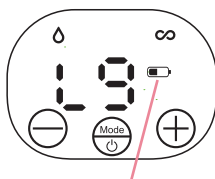

Battery Low

- When the battery indicator shows 1 bar battery power is low.
- When the battery symbol flashes, the battery power is extremely low and needs to be re-charged.
- When the battery indicator shows 2 bars the battery is fully charged.
- The battery will take approximately 3 hours to fully charge.

Note: This product is not supplied with a power adaptor. The adaptor output requires 5V $\overline{\text{---}}$ 1A to charge.

Using the Electric Breast Pump

- Wash your hands thoroughly with soap and water before use.
- Before starting, it is recommended to either gently massage the breast with your hands or apply a warm, moist towel to the breast for a few minutes to help promote milk flow.
- Clean the breast and nipple with clean cotton balls or a wet cloth before using the product.

Note: For the most comfortable use, please wear a nursing bra when using the product.

1. Ensure the Breast Pump is clean and assembled correctly (refer to pages 10 – 11). Use the appropriate Funnel Insert according to your nipple size, as indicated in the size guide on page 9.
2. Place the Breast Pump comfortably over the breast with the nipple centred in the opening of the shield creating a vacuum seal.

Note: Ensure the product is placed in the correct position by leaning your upper body slightly forward.



Adjustable Bra Strap

- If required, use the adjustable bra strap to connect with your nursing bra and then adjust the length accordingly.
- Place one end of the Adjustment Bra Strap on the inside buckle of the nursing bra.
- The length of the bra strap can be adjusted by changing the nursing bra buckle on the other end of the Bra Adjustment Buckle.

Using the Electric Breast Pump (cont'd)

Adjustable Bra Strap (cont'd)

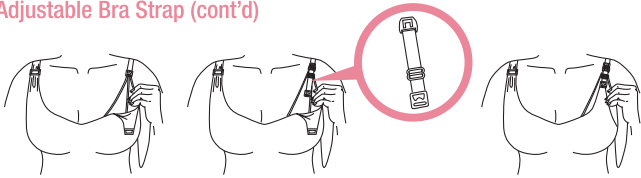

Adjusting the length of bra straps will make suction more comfortable.

Using the Breast Pump

1. Press **ON/OFF**  button to turn the breast pump on. The device will automatically start on **Massage Mode** ∞ .
2. After 2 minutes, the breast milk will flow freely, and the breast pump will switch automatically to the **Suction Mode** Δ .





Note: If your milk starts flowing earlier you can switch the Mode selection button at any time.

3. When milk is flowing freely, you can use either **Suction Mode** Δ or press **ON/OFF**  to choose **Expression Mode** $\Delta \infty$.



Suction Levels

L 1 ~ L 9

Use the **Level Up**  to increase Suction Levels and **Level Down**  to decrease Suction Levels to your preferred level.

The higher the Suction Level, the stronger the suction.

Note: The Suction Level will default to the last used suction level (or Level 1 when used for the first time).

Using the Electric Breast Pump (cont'd)

Completing Expression

The **Breast Pump** will automatically switch off after 30 minutes. Turn back on if needed.

The **Milk Collector** will hold up to 150mL of milk.

When expression is complete:

1. To avoid leakage, lean forward and keep pumping for a few seconds after completion. This ensures the remaining breast milk from the channel is captured in the milk collector.

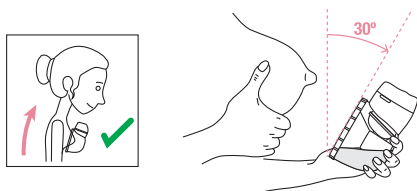

2. Press, and hold the **ON/OFF**  button for 2 seconds to turn the power off.
3. Remove the Breast Pump from the breast and keep the breast shield facing up.
4. Remove the motor from the top of the product.

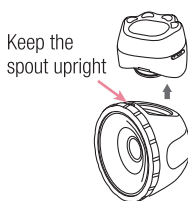

Please note: Keep the spout in the upright position to avoid any spillage.

5. Transfer the breast milk through the spout, directly into your preferred storage container.

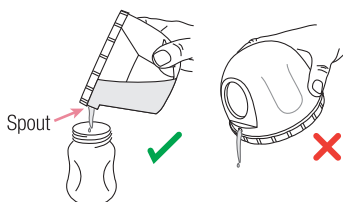

Note: To avoid spillage, please ensure you pour the milk from the correct position.

Storage of Breast Milk

Method of storing milk	Use within	REMEMBER
Room temperature <25°C	6 hours	<ul style="list-style-type: none">• Never defrost or heat in a microwave• Never refreeze breast milk• Once defrosted, the milk should be kept in the fridge and used within 12 hours• Do not boil breast milk• Throw away any leftover milk after a feed
Refrigerated at 5-10°C	3 days	
Refrigerated at 0-4°C	6 days	
Refrigerated before freezing	24 hours	
Once frozen	6 months	
Defrost before feeding	12 hours	

- Stored milk separates out into layers. Shake to remix thoroughly before feeding.
- When freezing milk, allow space at the top of the bottle for expansion.
- Thaw frozen milk in the fridge or by standing the bottle in lukewarm water until it has reached body temperature.
- If expressed milk is to be taken out with you, make sure it stays cold or frozen until needed.

Cleaning and Maintenance

Always wash the product immediately after use to remove milk residue.

- Remove the Pump Motor before cleaning.
- Disassemble all components.
- Use a soft, dry cloth to clean the display and exterior of the Pump Motor.
- **DO NOT** submerge the Pump Motor in water. The Pump Motor cannot be washed or sterilised.

Cleaning and Maintenance (cont'd)

- The Milk Collector and all its components can be cleaned using the following options. Before sterilisation, wash all items to be sterilised in warm soapy water and rinse thoroughly in clean water.

Steam Sterilisation

1. Use a steam steriliser to clean and disinfect thoroughly. Follow the manufacturer's instructions.

Boiling

1. Boil all components in boiling water for 5 minutes. Ensure the parts do not touch the side of the pan to avoid deformation.
2. Allow to air dry before next use.

DO NOT clean with solvents or harsh chemicals.

DO NOT put in the dishwasher.

DO NOT use a dry heater or dry steriliser.

Storage

- Wipe away any dirt or dust from the product.
- Turn off using the **ON/OFF**  button and store inside the supplied carry bag.
- Store in a safe, cool, dry place away from children as per Safety Warnings.

Troubleshooting

Fault	Problem	Solution
Weak suction	The components are wet	Dry all parts
	Components have not connected well	Check all the connection parts and reassemble all the components
	The battery is low on power	Recharge the battery for 3 hours
	There are cracks on the Breast Shield	Replace the Breast Shield
	The Breast Shield spout or the Milk Collector has not sealed tightly	Check whether the spout is aligned and sealed tightly
	The Breast Shield is not attaching securely to the breast	Ensure the Breast Shield is placed as closely as possible to the breast
No suction	No Silicone Valve has been used or the Silicone Valve is damaged	Reassemble or replace with a new Silicone Valve
	No Silicone Diaphragm has been used or the Silicone Diaphragm is damaged	Reassemble or replace with a new Silicone Diaphragm
	The Silicone Diaphragm and the Linker has not connected securely	Ensure the Linker inside the internal slot of the Milk Collector and the diaphragm is sealed with the Milk Collector tightly
	The Funnel Insert used may be too small	Choose a larger sized Funnel Insert

Troubleshooting (cont'd)

Fault	Problem	Solution
The product is not turning on	The battery has run out of power	Recharge the battery for 3 hours
Milk leakage	The Funnel Insert used may be too large	Choose a smaller sized Funnel Insert
Tingling nipple	The Funnel Insert used may be too small	Choose a larger sized Funnel Insert

If the problem is not solved by the troubleshooting guide or you have any queries, please contact our service centre:

In Australia: 1800 807 464 **In New Zealand:** 0800 523 583

DO NOT attempt to open or repair the product yourself.

Replacement Accessories (sold separately)

Part Name	Part No.
Lock Ring	WNBP-01
Silicone Valve	WNBP-02
Pump Motor	WNBP-03
Milk Collector	WNBP-04
USB Cable	WNBP-05
Silicone Seal	WNBP-06















Part Name	Part No.
Funnel Insert - Sm	WNBP-07
Funnel Insert - Med	WNBP-08
Funnel Insert - Lg	WNBP-09
Linker	WNBP-10
Silicone Diaphragm	WNBP-11
Breast Shield	WNBP-12

Replacement accessories can be purchased online or by contacting us directly:







Australia: 1800 807 464 or www.welcare.com.au

New Zealand: 0800 523 583 or www.jadavey.co.nz

Symbol Explanation

Symbol	Description
	The instruction manual/booklet must be read.
	Manufacturer.
	Caution is necessary.
	Batch or lot code.
	Do not use if package is damaged.
	Temperature limit.
	Humidity limitation.
	Battery, general.
	Australian Communications Media Authority (ACMA) Regulatory Compliance Mark (RCM).
	Product is compliant with all applicable European Union Directives for health, safety, performance and environment.
	Product does not contain natural rubber latex.
	Product does not contain Bisphenol A.
	Product does not contain phthalate plasticizers DEHP, DIBP, BBP or DBP.
	Separate collection for electrical and electronic waste. Do not dispose of battery in household waste. CONTAINS LITHIUM BATTERY.

Technical Data

Product Name	Welcare Nurture Wearable Electric Breast Pump
Model Number	WNB100
Contents	1 x Breast Pump 3 x Funnel (3 sizes) 1 x Type-C USB Charging Cable 1 x Storage Bag 1 x Bra Strap 1 x User Manual & Warranty Information
Suction Power	Up to 320mmHg
Suction Control	9 Levels
Usage Time	≤ 150 minutes
Decibels	≤ 55dB
Power	Maximum 5W
Adaptor Output Requirement	5V  1A
Battery	Lithium-ion 3.7V 1200mAh 4.44Wh
Charging Time	3 Hours
Operating Conditions	 Temperature: 5°C to 40°C  Humidity: 0% to 75% (non-condensing)  Atmospheric Pressure: 700hPa to 1013h.25Pa
Storage/ Transport Conditions	 Temperature: -20°C to 60°C  Humidity: 0% to 85% (non-condensing)  Atmospheric Pressure: 700hPa to 1013.25hPa
Dimensions	150mm (H) x 114mm (W) x 80mm (D)
Weight	Net 140g, Gross 442g
Material	Silicone, Acrylonitrile Butadiene Styrene, Polypropylene.
Milk Collector Capacity	150mL

Product Warranty Information

Please register your warranty information at:

AUS - www.jadavey.com.au NZ – www.jadavey.co.nz

This Welcare Nurture product is warranted to be free of manufacturing defects for 1 year from the date of purchase*. This warranty is void if the product is modified or altered, is subject to misuse or abuse, damaged in transit or lack of responsible care, is dropped, if damage occurs by reason of failure to follow the written instruction manual, or if product repairs are carried out without authority from J A Davey Pty Ltd.

We will repair, or at our option replace free of charge, any parts necessary to correct material or workmanship, or replace the entire product and return to you during the period of the warranty. Otherwise, we will quote for any repair which will be carried out on acceptance of our quotation. The benefits conferred by this Warranty are in addition to all other rights and remedies in respect of Product which the Consumer has under the Australian Consumer Law and other State or Territory laws in Australia and New Zealand (as applicable).

Our goods come with guarantees that cannot be excluded under Australian and New Zealand Consumer Law. You are entitled to a replacement or refund for a major failure and for compensation for any other reasonably foreseeable loss or damage. You are also entitled to have the goods repaired or replaced if the goods fail to be of acceptable quality and the failure does not amount to a major failure.

**Please note the battery and accessories are not covered under warranty.*

Product Warranty Information (cont'd)

BEFORE YOU SEND IN YOUR UNIT FOR SERVICE

Before sending in your product for service, please take a few minutes to do the following:

- To ensure safe and correct use, storage and cleaning, please ensure you review the Instruction Manual in full. The Instruction Manual can be downloaded online.
- In your instruction manual, read the troubleshooting section that describes common errors, their cause, and remedies.
- Contact Welcare customer service. Our staff are trained to assist you with most issues you may have experienced, without the need to send your product in for service.

PLEASE CALL OUR TOLL-FREE NUMBER:

IN AUSTRALIA: Free call: 1800 807 464

IN NEW ZEALAND: Free call: 0800 523 583

SENDING IN YOUR UNIT FOR SERVICE

1. Should repair be needed within the warranty period, enclose the cut-out section of the warranty form and your proof of purchase receipt. Please ensure all relevant details are completed before sending your unit in for service. Please ensure your contact details are still current and include a brief description of the problem you are experiencing together with your purchase receipt.
2. Include the unit with all product components in your package. This is extremely important, so our repair technicians can make the correct diagnosis with any problems.
3. Please return the product and warranty form at your cost to:

IN AUSTRALIA

J A DAVEY PTY LTD

Welcare Repairs

PO Box 84

Port Melbourne

Victoria, Australia 3207

IN NEW ZEALAND

BV Medical Welcare Repairs

Unit 7, 110 Mays Road

Onehunga,

Auckland, New Zealand 1061



Warranty Form

**PLEASE RETAIN THE WARRANTY INFORMATION.
RETURN THIS PORTION ONLY WHEN YOU RETURN YOUR PRODUCT FOR
REPAIR UNDER WARRANTY.**

Our Privacy Policy can be found here <https://jadavey.com.au/privacy-policy/>

NAME:

ADDRESS:

POSTCODE:

DAYTIME PHONE:

EMAIL:

MODEL:

DATE OF PURCHASE: / / (PLEASE ATTACH PROOF OF PURCHASE)

RETAILER'S NAME:

RETAILER'S ADDRESS:

POSTCODE:

BRIEF DESCRIPTION OF PROBLEM YOU ARE EXPERIENCING:



Warranty is void unless the above information is completed and correct.



Should you require any further information please do not hesitate to contact us.

Manufactured for:

IN AUSTRALIA:

J A DAVEY PTY LTD
626 Lorimer Street
Port Melbourne, VIC 3207
Telephone: 1800 807 464
Website: www.jadavey.com.au

IN NEW ZEALAND:

J A DAVEY LTD
C/- Healthcare Logistics
58 Richard Pearse Drive
Mangere, Auckland 2022
Telephone: 0800 523 583
Website: www.jadavey.co.nz

Disposal



At the end of its life, please treat this product as electronic waste and dispose of responsibly according to current local regulations.

**Collect batteries separately for recycling.
CONTAINS LITHIUM BATTERY**



Made in China

WELCARE 
NURTURE

WEARABLE ELECTRIC BREAST PUMP



Model: WNB100

V08/23